

## BNSF RAIL SERVED SITE



## Lincoln Prairie Eldamain & Faxon Roads Yorkville, IL 60560

- 228 Acre Industrial Park (divisible)
- Zoned M-2 (General Manufacturing District)
- BNSF Spur already in place with established service 7 days a week
- A diverse, highly skilled and well-educated labor force
- Yorkville Area Corporate neighbors include: Menards Distribution Facility, ComEd, Wrigley Manufacturing
- Low Kendall County Real Estate Taxes
- Incentives Available
- Topo and survey are complete
- Drain tile locations complete

Joyce M. Slone, SIOR, CCIM  
708.302.3570

340 W. Butterfield Road, Suite 4B  
Elmhurst, Illinois 60126

joyce@slonecommercial.com  
www.slonecommercial.com

The information above has been obtained from sources believed reliable. While we do not doubt its accuracy, we have not verified it and make no guarantee, warranty or representation about it. It is your responsibility to independently confirm its accuracy and completeness. Any projections, opinions, assumptions or estimates used are for example only and do not represent the current or future performance of the property. The value of this transaction to you depends on tax and other factors which should be evaluated by your tax, financial and legal advisors. You and your advisors should conduct a careful, independent investigation of the property to determine to your satisfaction the suitability of the property for your needs.

**Lincoln Prairie  
Eldamain & Faxon Roads  
Yorkville, IL 60560**

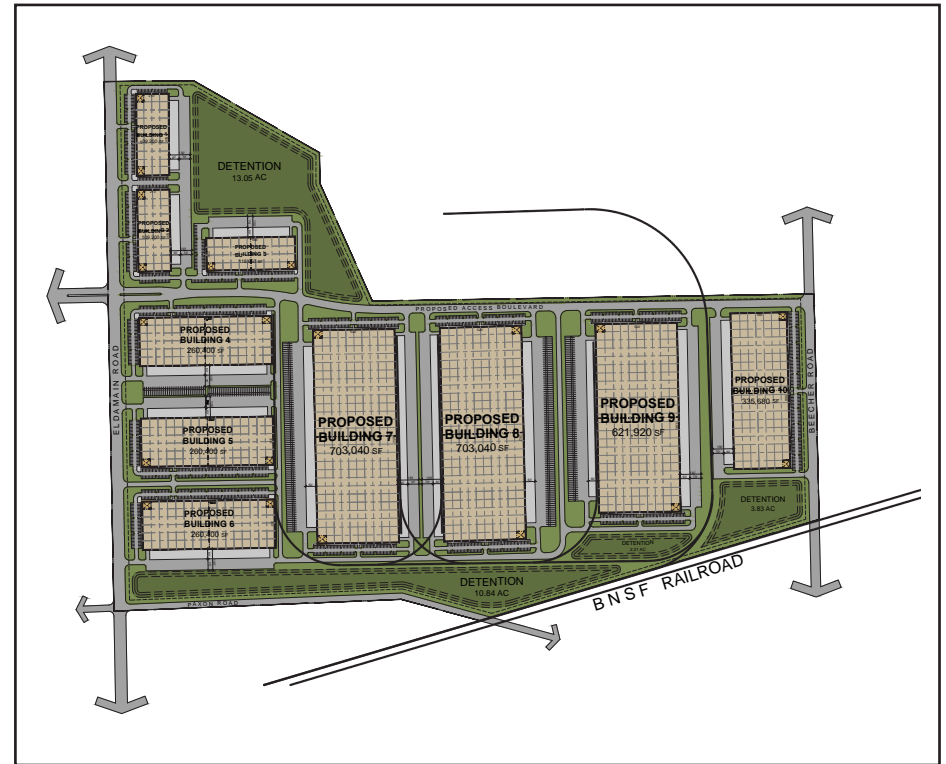
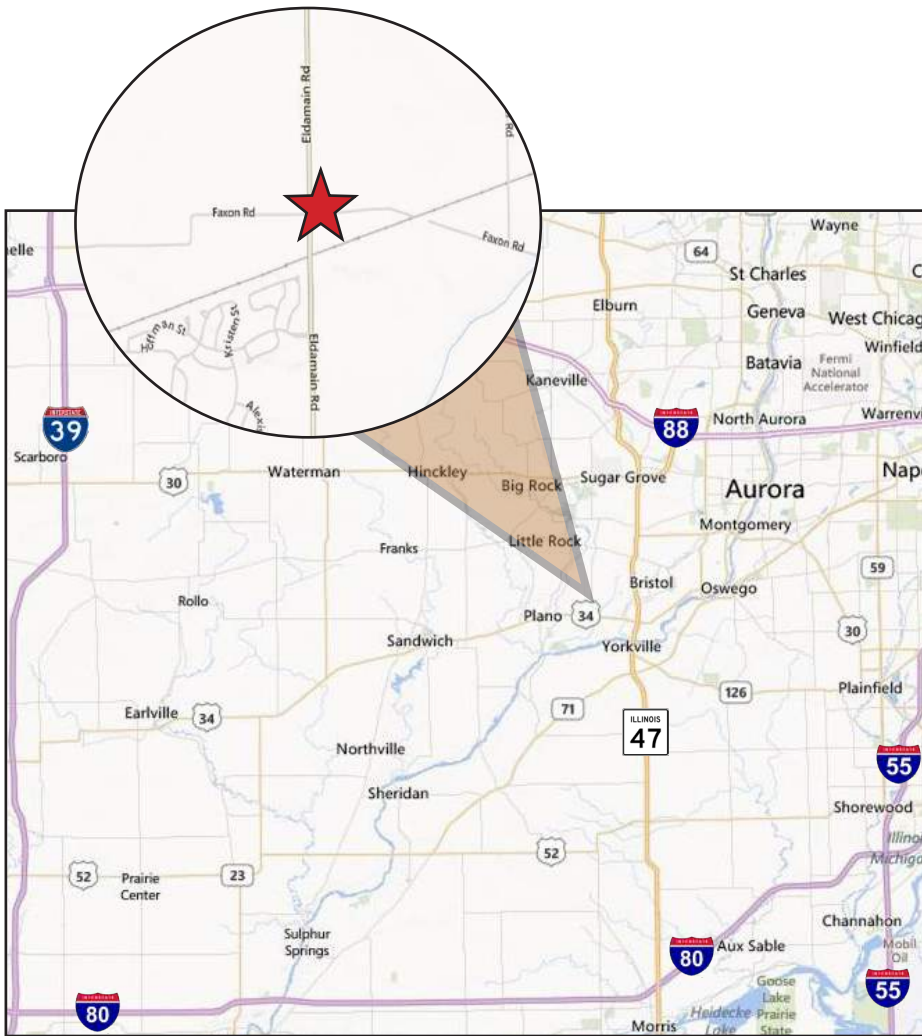

Joyce M. Slone, SIOR, CCIM  
708.302.3570

340 W. Butterfield Road, Suite 4B  
Elmhurst, Illinois 60126

joyce@slonecommercial.com  
www.slonecommercial.com

The information above has been obtained from sources believed reliable. While we do not doubt its accuracy, we have not verified it and make no guarantee, warranty or representation about it. It is your responsibility to independently confirm its accuracy and completeness. Any projections, opinions, assumptions or estimates used are for example only and do not represent the current or future performance of the property. The value of this transaction to you depends on tax and other factors which should be evaluated by your tax, financial and legal advisors. You and your advisors should conduct a careful, independent investigation of the property to determine to your satisfaction the suitability of the property for your needs.